

# THOMAS BROWN

ESTATES



**25 Woodcote Drive, Orpington, BR6 8DB**

**Fixed Price: £465,000**

- 3 Bedroom Extended Mid-Terrace House
- Close to Orpington & Petts Wood Stations
- Close to Many Sought After Schools
- Dual Aspect 26' Lounge/Dining Room







## Property Description

Thomas Brown Estates are delighted to offer this well presented, extended three bedroom terrace property boasting a garage en bloc and close proximity to Orpington and Petts Wood Station, Crofton Primary School and Darrick Wood Schools. The accommodation on offer comprises: entrance hallway, spacious dual aspect 26' lounge/dining room with direct access to the rear garden and an extended kitchen also with access to the rear garden to the ground floor. To the first floor are three bedrooms (two being good size doubles) and a modern family bathroom. Externally there is a well kept garden to the rear perfect for entertaining, ample on road parking and a garage en bloc. Please call Thomas Brown Estate Agents in Orpington to arrange a viewing to appreciate the floorspace and central location on offer.





#### ENTRANCE HALL

Double glazed opaque door to front, opaque panels to front and side, large storage cupboard, carpet, radiator.

#### LOUNGE/DINER

26' 0" x 12' 10" (7.92m x 3.91m) Double glazed window to front, double glazed sliding door to rear, under stairs storage cupboard, carpet, two radiators.

#### KITCHEN

15' 0" x 7' 09" (4.57m x 2.36m) Range of matching wall and base units with worktops over, one and a half bowl sink and drainer, integrated gas hob and oven with extractor over, space for fridge/freezer, space for washing machine, double glazed door to side, double glazed window to side and rear, vinyl flooring.

#### STAIRS TO FIRST FLOOR LANDING

Storage cupboard, loft access, carpet.

#### BEDROOM 1

13' 0" x 9' 04" (3.96m x 2.84m) Built in wardrobes, double glazed window to front, carpet, radiator.

#### BEDROOM 2

10' 0" x 9' 08" (3.05m x 2.95m) Built in wardrobes, double glazed window to rear, carpet, radiator.

#### BEDROOM 3

9' 10" x 6' 05" (3m x 1.96m) (measured at maximum) Storage cupboard, double glazed window to front, carpet, radiator.

#### BATHROOM

Low level WC, wash hand basin in vanity unit, bath with shower over and attachment, double glazed opaque window to rear, tiled walls, vinyl flooring, heated towel rail.

#### OTHER BENEFITS INCLUDE:

#### GARDEN

34' 0" x 17' 0" (10.36m x 5.18m) Patio area with rest laid to lawn, side access.

#### GARAGE EN-BLOC

Up and over door.

#### DOUBLE GLAZING

#### CENTRAL HEATING SYSTEM

#### MAINTENANCE CHARGE

£90 PA.



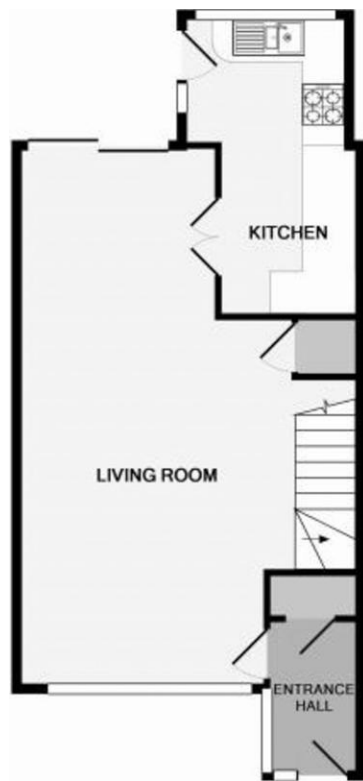

GROUND FLOOR  
APPROX. FLOOR  
AREA 479 SQ.FT.  
(44.5 SQ.M.)

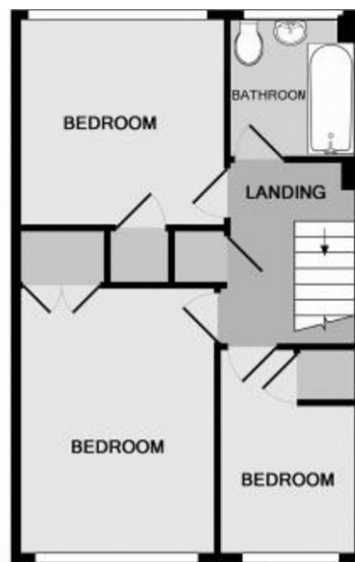

1ST FLOOR  
APPROX. FLOOR  
AREA 410 SQ.FT.  
(38.1 SQ.M.)

TOTAL APPROX. FLOOR AREA 888 SQ.FT. (82.5 SQ.M.)

Whilst every attempt has been made to ensure the accuracy of the floor plan contained here, measurements of doors, windows, rooms and any other items are approximate and no responsibility is taken for any error, omission, or mis-statement. This plan is for illustrative purposes only and should be used as such by any prospective purchaser. The services, systems and appliances shown have not been tested and no guarantee as to their operability or efficiency can be given.

Made with Metropix ©2014



**Construction: Standard**

**Council Tax Band: D**

**Tenure: Freehold**

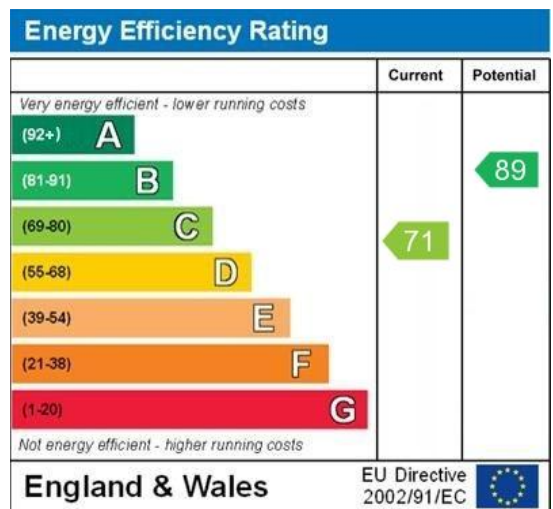

WWW.EPC4U.COM

No statement in these details is to be relied upon as representation of fact, and purchasers should satisfy themselves by inspection or otherwise as to the accuracy of the statements contained within. These details do not constitute any part of any offer or contract. Thomas Brown Estates and their employees and agents do not have any authority to give warranty or representation whatsoever in respect of this property. These details and all statements herein are provided without any responsibility on the part of Thomas Brown Estates or the vendors.

Thomas Brown Estates have not tested the equipment or central heating system mentioned in these particulars and the purchasers are advised to satisfy themselves as to the working order and condition.

Measurements: Great care is taken when measuring, but measurements should not be relied upon for ordering carpets, equipment, etc.

The Laws of copyright protect this material. The Owner of the copyright is Thomas Brown Estates. This property sheet forms part of our database, and is protected by the database right and copyright laws. No unauthorised copying or distribution without permission.

Registered Office: Lawrence & Co, 94 Brook Street, Erith, DA8 1JF. Registered in England no. 6048974

285 High Street  
Orpington  
Kent  
BR6 0NN

[www.thomasbrownestates.co.uk](http://www.thomasbrownestates.co.uk)  
[sales@thomasbrownestates.co.uk](mailto:sales@thomasbrownestates.co.uk)

**01689 884444**

Telephones Manned:  
Mon-Fri: 8am – 8pm  
Sat: 8am – 5pm  
Sun: 10am – 4pm

**THOMAS BROWN**  
ESTATES